

Mtrx SPECIFIC HARDWARE

Front inserted steel clip nuts – for installation into frame posts and grid rails. Nuts slide on an angle into provides rectangle (25mm pattern) and are then rotated and translated to lock in place. Offer a reliable mechanical and electrical connection.



CATALOG NUMBER	DESCRIPTION	PACKS
880 HDFM05	M5 thread	100
880 HDFM06	M6 thread	100
880 HDFM08	M8 thread	100

Standard steel clip nuts for grid rails – for installation into grid rails (6500 MXG or 6500 MXGQ)



CATALOG NUMBER	DESCRIPTION	PACKS
880 HDPM08	M8 thread	100
880 HD3118	5/16"-18UNC	100

Standard steel clip nuts for rack angles (19", 23", 24") – for installation into rack angles (6500 MXL).



CATALOG NUMBER	DESCRIPTION	PACKS
880 HDPM05	M5 thread	100
880 HDPM06	M6 thread	100
880 HDP2520	1/2"-20UNC	100

Hex socket cap screw – installation hardware for inner mounting panel. Can be used with front inserted steel clip nuts



CATALOG NUMBER	DESCRIPTION	PACKS
880 HDHXM0512	M5 x 12mm	100
880 HDHXM0612	M6 x 12mm	100
880 HDHXM0812	M8 x 12mm	100
880 HDHXM1220	M12 x 20mm	25

Self tapping screw – for installation of accessories onto frame (25mm hole pattern), door stiffeners and grid rails. M6 hardware is for taping in vertical post external mounting holes.



CATALOG NUMBER	DESCRIPTION	PACKS
880 HDTRM0508	M5 x 8mm	100
880 HDTRM0510	M5 x 10mm	100
880 HDTRM0610	M6 x 10mm	100

Machine screw – for installation of accessories into front or standard clip nuts or accessories throughout.

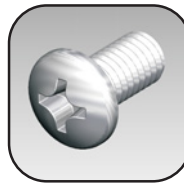

CATALOG NUMBER	DESCRIPTION	PACKS
880 HDM0632	6-32 UNC - 3/8"	100
880 HDM0832	8-32 UNC - 3/8"	100
880 HDM1024	10-24 UNC - 3/8"	100
880 HDM1032	10-32 UNF - 3/8"	100
880 HDMM04	M4 - 12mm	100
880 HDMM0425	M4 - 25mm	50
880 HDMM05	M5 - 12mm	100
880 HDMM06	M6 - 12mm	100
880 HDMM08	M8 - 25mm	50
880 HDMM10	M10 - 25mm	50

Side and rear cover machine screw with mechanical stop – standard installation hardware for side and rear covers.



CATALOG NUMBER	DESCRIPTION (Flat head)	PACKS
880 HDMFM0616	M6 (Philips drive)	50
880 HDMFM0812	M8 (Hex socket)	25

Tamperproof hardware – installation hardware for side and rear covers. Special driver bit required for installation – fits in standard 1/2" hex driver.



CATALOG NUMBER	DESCRIPTION	PACKS
886 HDZS	Zinc-plated M6	18
886 HDSS	Stainless M6	18
886 HDBIT	Tamperproof	2

Data subject to change without notice.