

Double bay frame

The 6500 MX is the base frame of a Mtrx cabinet. The fully welded frame is made of powder coated **electro-galvanized steel and steel cast corners**. The tube-shaped roller formed design features an exclusive stiffening rib. This special stiffening rib consists

of three layers of material (4.5mm) all along the frame's inner edges. The frame design is fully symmetric. This facilitates installation and accessory selection. A hole pattern which can accommodate front inserted M8 clip nuts is present at 25 mm

increments. Self-tapping holes for M5 screws are provided. Inner panel sliding rails, eyebolts and leveling feet are also provided. The frame is RAL7011 sandtex dark gray.



STEP 1: INSERT INTO RECTANGULAR CUTOUT

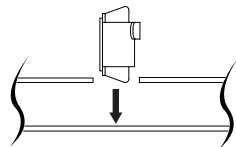

STEP 2: ROTATE AND SLIDE INTO CUTOUT

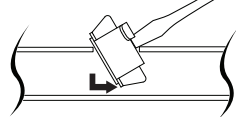

STEP 3: PUSH UNTIL SPRING IS ENGAGED

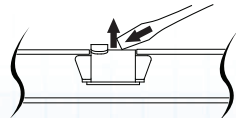

All modular frames are supplied with a hole pattern offset every 25mm to accommodate the installation of front inserted clip nuts (p.148) in all three axes. Refer to above steps for installation

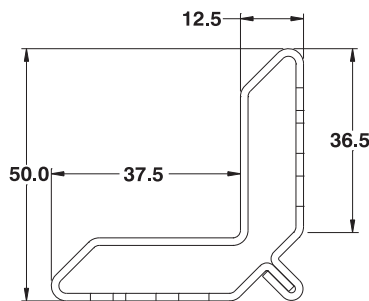

FOR M5 SELF TAPPING HARDWARE (880 HDT14, SEE PAGE 472)

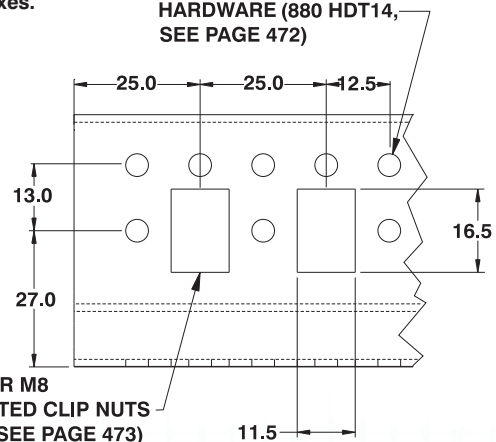

FOR M5, M6 OR M8 FRONT INSERTED CLIP NUTS (880 HDFM..., SEE PAGE 473)

Data subject to change without notice.



Solid Doors	Window Doors	Side Doors	Back Covers	Side Covers	Dress Frames	Mounting Panel
p.22	p.24	p.38	p.32	p.36	p.128	p.39

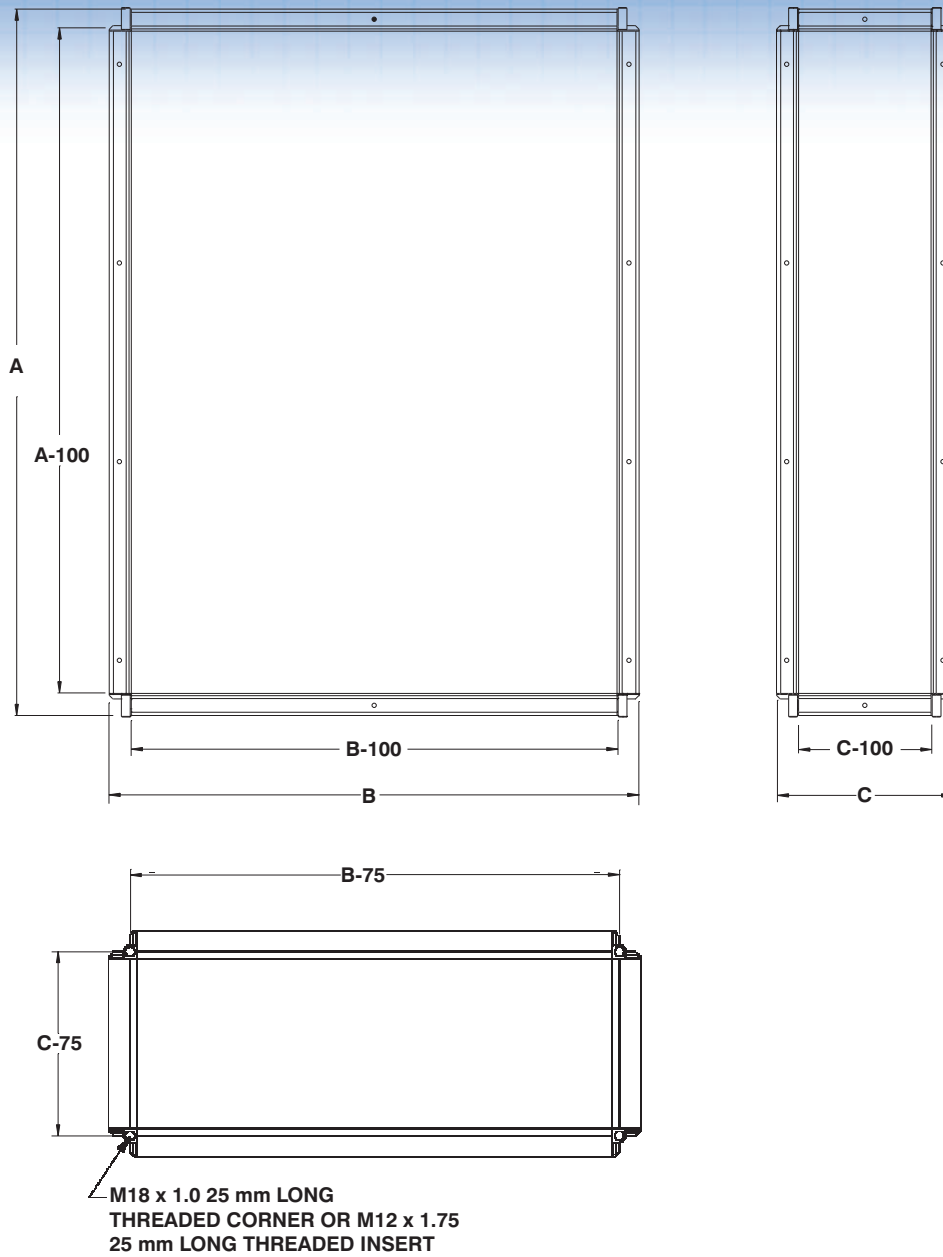

CATALOG NUMBER	NOMINAL			DIMENSIONS		
	H	W	D	A	B	C
6500 MX071206	700	1200	600	700	1200	600
6500 MX141204	1400	1200	400	1400	1200	400
6500 MX141205	1400	1200	500	1400	1200	500
6500 MX141604	1400	1600	400	1400	1600	400
6500 MX141605	1400	1600	500	1400	1600	500
6500 MX161204	1600	1200	400	1600	1200	400
6500 MX161205	1600	1200	500	1600	1200	500
6500 MX161206	1600	1200	600	1600	1200	600
6500 MX161208	1600	1200	800	1600	1200	800
6500 MX181204	1800	1200	400	1800	1200	400
6500 MX181205	1800	1200	500	1800	1200	500
6500 MX181206	1800	1200	600	1800	1200	600
6500 MX181208	1800	1200	800	1800	1200	800
6500 MX181604	1800	1600	400	1800	1600	400

CATALOG NUMBER	NOMINAL			DIMENSIONS		
	H	W	D	A	B	C
6500 MX181605	1800	1600	500	1800	1600	500
6500 MX181606	1800	1600	600	1800	1600	600
6500 MX181608	1800	1600	800	1800	1600	800
6500 MX201204	2000	1200	400	2000	1200	400
6500 MX201205	2000	1200	500	2000	1200	500
6500 MX201206	2000	1200	600	2000	1200	600
6500 MX201208	2000	1200	800	2000	1200	800
6500 MX201604	2000	1600	400	2000	1600	400
6500 MX201605	2000	1600	500	2000	1600	500
6500 MX201606	2000	1600	600	2000	1600	600
6500 MX201608	2000	1600	800	2000	1600	800
6500 MX221205	2200	1200	500	2200	1200	500
6500 MX221206	2200	1200	600	2200	1200	600
6500 MX221208	2200	1200	800	2200	1200	800

Data subject to change without notice.

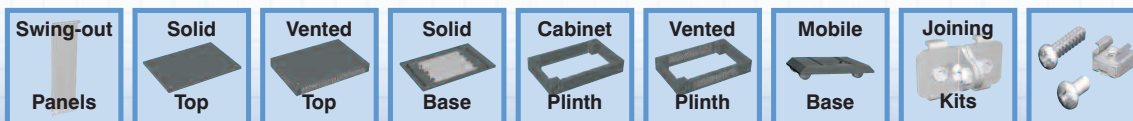

<http://www.exmweb.com>
[p.44](http://www.exmweb.com)
[p.50](http://www.exmweb.com)
[p.55](http://www.exmweb.com)
[p.56](http://www.exmweb.com)
[p.58](http://www.exmweb.com)
[p.59](http://www.exmweb.com)
[p.60](http://www.exmweb.com)
[p.104](http://www.exmweb.com)
[p.148](http://www.exmweb.com)

1-800-363-2423

Fax : 450-979-4626

info@exmweb.com