

Single bay cabinet kit with top cable entry gland plate

The 6100 SLK cabinet kit is comparable to the Mtrx kit in form, fit and function however designed for NEMA 1 rated applications. The standard cabinet kits consists of:

- 6100 SL frame with incorporated top and bottom (painted dark gray RAL7011; galvanized) and accessory kit (cable entry caps & gland plates; eye bolts; leveling feet) (p.141)
- 6100 SLR rear cover (painted light gray RAL7035; steel) (p. 97)
- 6100 SLD solid door (painted light gray RAL7035; steel) - consisting of: a 4 point locking mechanism; vertical stiffeners; a zinc cast pull handle with slotted insert (p.92)
- 6100 SLM inner mounting panel (no finish 12ga galvanized) (p.101)
- 4 std leveling feet
- 4 lifting eye bolts

CSA Certified / UL Listed
NEMA/EEMAC 1 / IP30



STEP 1: INSERT INTO RECTANGULAR CUTOUT

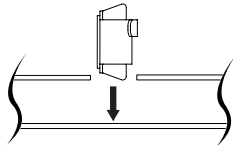

STEP 2: ROTATE AND SLIDE INTO CUTOUT

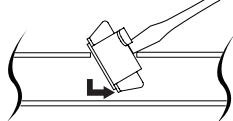

STEP 3: PUSH UNTIL SPRING IS ENGAGED

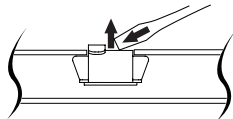

All modular frames are supplied with a hole pattern offset every 25mm to accommodate the installation of front inserted clip nuts (p.148) in all three axes. Refer to above steps for installation

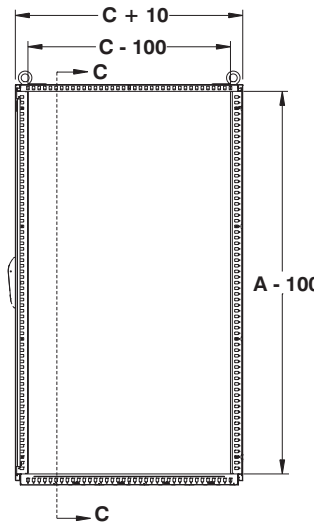
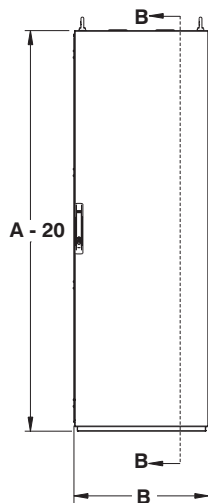
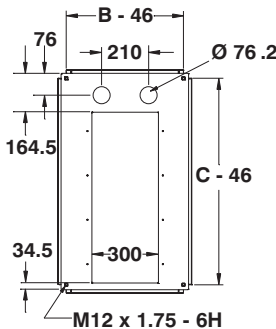

SECTION B-B

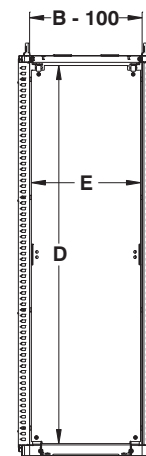

SECTION C-C

CATALOG NUMBER	NOMINAL			PANEL	
	A	B*	C	D	E
6100 SLK070604CE	700	600	400	580	485
6100 SLK070605CE	700	600	500	580	485
6100 SLK070606CE	700	600	600	580	485
6100 SLK070608CE	700	600	800	580	485
6100 SLK070609CE	700	600	900	580	485
6100 SLK070610CE	700	600	1000	580	485
6100 SLK070611CE	700	600	1100	580	485
6100 SLK070612CE	700	600	1200	580	485
6100 SLK070704CE	700	700	400	580	585
6100 SLK070705CE	700	700	500	580	585
6100 SLK070706CE	700	700	600	580	585
6100 SLK070708CE	700	700	800	580	585
6100 SLK070709CE	700	700	900	580	585

CATALOG NUMBER	NOMINAL			PANEL	
	A	B*	C	D	E
6100 SLK070710CE	700	700	1000	580	585
6100 SLK070711CE	700	700	1100	580	585
6100 SLK070712CE	700	700	1200	580	585
6100 SLK070804CE	700	800	400	580	685
6100 SLK070805CE	700	800	500	580	685
6100 SLK070806CE	700	800	600	580	685
6100 SLK070809CE	700	800	900	580	685
6100 SLK070810CE	700	800	1000	580	685
6100 SLK070811CE	700	800	1100	580	685
6100 SLK070812CE	700	800	1200	580	685
6100 SLK140604CE	1400	600	400	1280	485
6100 SLK140605CE	1400	600	500	1280	485
6100 SLK140606CE	1400	600	600	1280	485

Data subject to change without notice.

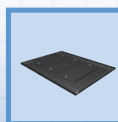

p.56

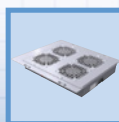

p.52

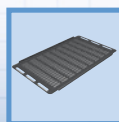

p.57

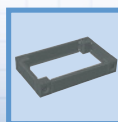

p.58



p.105

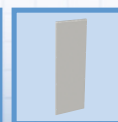

p.42

Single bay cabinet kit with top cable entry gland plate

CATALOG NUMBER	NOMINAL			PANEL	
	A	B*	C	D	E
6100 SLK140608CE	1400	600	800	1280	485
6100 SLK140609CE	1400	600	900	1280	485
6100 SLK140610CE	1400	600	1000	1280	485
6100 SLK140611CE	1400	600	1100	1280	485
6100 SLK140612CE	1400	600	1200	1280	485
6100 SLK140704CE	1400	700	400	1280	585
6100 SLK140705CE	1400	700	500	1280	585
6100 SLK140706CE	1400	700	600	1280	585
6100 SLK140708CE	1400	700	800	1280	585
6100 SLK140709CE	1400	700	900	1280	585
6100 SLK140710CE	1400	700	1000	1280	585
6100 SLK140711CE	1400	700	1100	1280	585
6100 SLK140712CE	1400	700	1200	1280	585
6100 SLK140804CE	1400	800	400	1280	685
6100 SLK140805CE	1400	800	500	1280	685
6100 SLK140806CE	1400	800	600	1280	685
6100 SLK140808CE	1400	800	800	1280	685
6100 SLK140809CE	1400	800	900	1280	685
6100 SLK140810CE	1400	800	1000	1280	685
6100 SLK140811CE	1400	800	1100	1280	685
6100 SLK140812CE	1400	800	1200	1280	685
6100 SLK160604CE	1600	600	400	1480	485
6100 SLK160605CE	1600	600	500	1480	485
6100 SLK160606CE	1600	600	600	1480	485
6100 SLK160608CE	1600	600	800	1480	485
6100 SLK160609CE	1600	600	900	1480	485
6100 SLK160610CE	1600	600	1000	1480	485
6100 SLK160611CE	1600	600	1100	1480	485
6100 SLK160612CE	1600	600	1200	1480	485
6100 SLK160704CE	1600	700	400	1480	585
6100 SLK160705CE	1600	700	500	1480	585
6100 SLK160706CE	1600	700	600	1480	585
6100 SLK160708CE	1600	700	800	1480	585
6100 SLK160709CE	1600	700	900	1480	585
6100 SLK160710CE	1600	700	1000	1480	585
6100 SLK160711CE	1600	700	1100	1480	585
6100 SLK160712CE	1600	700	1200	1480	585
6100 SLK160804CE	1600	800	400	1480	685
6100 SLK160805CE	1600	800	500	1480	685
6100 SLK160806CE	1600	800	600	1480	685
6100 SLK160808CE	1600	800	800	1480	685
6100 SLK160809CE	1600	800	900	1480	685
6100 SLK160810CE	1600	800	1000	1480	685
6100 SLK160811CE	1600	800	1100	1480	685
6100 SLK160812CE	1600	800	1200	1480	685
6100 SLK180604CE	1800	600	400	1680	485
6100 SLK180605CE	1800	600	500	1680	485
6100 SLK180606CE	1800	600	600	1680	485
6100 SLK180608CE	1800	600	800	1680	485
6100 SLK180609CE	1800	600	900	1680	485
6100 SLK180610CE	1800	600	1000	1680	485
6100 SLK180611CE	1800	600	1100	1680	485
6100 SLK180612CE	1800	600	1200	1680	485
6100 SLK180704CE	1800	700	400	1680	585
6100 SLK180705CE	1800	700	500	1680	585
6100 SLK180706CE	1800	700	600	1680	585
6100 SLK180708CE	1800	700	800	1680	585
6100 SLK180709CE	1800	700	900	1680	585
6100 SLK180710CE	1800	700	1000	1680	585

CATALOG NUMBER	NOMINAL			PANEL	
	A	B*	C	D	E
6100 SLK180711CE	1800	700	1100	1680	585
6100 SLK180712CE	1800	700	1200	1680	585
6100 SLK180804CE	1800	800	400	1680	685
6100 SLK180805CE	1800	800	500	1680	685
6100 SLK180806CE	1800	800	600	1680	685
6100 SLK180808CE	1800	800	800	1680	685
6100 SLK180809CE	1800	800	900	1680	685
6100 SLK180810CE	1800	800	1000	1680	685
6100 SLK180811CE	1800	800	1100	1680	685
6100 SLK180812CE	1800	800	1200	1680	685
6100 SLK200604CE	2000	600	400	1880	485
6100 SLK200605CE	2000	600	500	1880	485
6100 SLK200606CE	2000	600	600	1880	485
6100 SLK200608CE	2000	600	800	1880	485
6100 SLK200609CE	2000	600	900	1880	485
6100 SLK200610CE	2000	600	1000	1880	485
6100 SLK200611CE	2000	600	1100	1880	485
6100 SLK200612CE	2000	600	1200	1880	485
6100 SLK200704CE	2000	700	400	1880	585
6100 SLK200705CE	2000	700	500	1880	585
6100 SLK200706CE	2000	700	600	1880	585
6100 SLK200708CE	2000	700	800	1880	585
6100 SLK200709CE	2000	700	900	1880	585
6100 SLK200710CE	2000	700	1000	1880	585
6100 SLK200711CE	2000	700	1100	1880	585
6100 SLK200712CE	2000	700	1200	1880	585
6100 SLK200804CE	2000	800	400	1880	685
6100 SLK200805CE	2000	800	500	1880	685
6100 SLK200806CE	2000	800	600	1880	685
6100 SLK200808CE	2000	800	800	1880	685
6100 SLK200809CE	2000	800	900	1880	685
6100 SLK200810CE	2000	800	1000	1880	685
6100 SLK200811CE	2000	800	1100	1880	685
6100 SLK200812CE	2000	800	1200	1880	685
6100 SLK220604CE	2200	600	400	2080	485
6100 SLK220605CE	2200	600	500	2080	485
6100 SLK220606CE	2200	600	600	2080	485
6100 SLK220608CE	2200	600	800	2080	485
6100 SLK220609CE	2200	600	900	2080	485
6100 SLK220610CE	2200	600	1000	2080	485
6100 SLK220611CE	2200	600	1100	2080	485
6100 SLK220612CE	2200	600	1200	2080	485
6100 SLK220704CE	2200	700	400	2080	585
6100 SLK220705CE	2200	700	500	2080	585
6100 SLK220706CE	2200	700	600	2080	585
6100 SLK220708CE	2200	700	800	2080	585
6100 SLK220709CE	2200	700	900	2080	585
6100 SLK220710CE	2200	700	1000	2080	585
6100 SLK220711CE	2200	700	1100	2080	585
6100 SLK220712CE	2200	700	1200	2080	585
6100 SLK220804CE	2200	800	400	2080	685
6100 SLK220805CE	2200	800	500	2080	685
6100 SLK220806CE	2200	800	600	2080	685
6100 SLK220808CE	2200	800	800	2080	685
6100 SLK220809CE	2200	800	900	2080	685
6100 SLK220810CE	2200	800	1000	2080	685
6100 SLK220811CE	2200	800	1100	2080	685
6100 SLK220812CE	2200	800	1200	2080	685

* Side panels (one on each side) add 10mm to width.



For exterior of cabinet finished textured black RAL9005 add suffix "X"
 6100 SLK180606CEX → cable entry version with external finish black RAL9005

Data subject to change without notice.

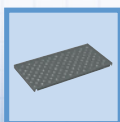

p.110

<http://www.exmweb.com>



p.113

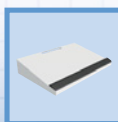

p.114



p.120



p.127



p.137



p.139



p.141



p.144

1-800-363-2423

Fax : 450-979-4626

info@exmweb.com